

# CITY OF MURRAY CONTROL MONUMENT CARD

DESIGNATION: E5 2010 A  
TYPE: 30" POURED CONCRETE MONUMENT W/ CITY DISK  
DATE SET: JUNE 2010 QUAD: DEXTER, KY.  
HORIZONTAL DATUM: NAD-83 (NSRS 2007)  
VERTICAL DATUM: NAVD-88 (GPS) ZONE: KY. S 1602

NORTHING: 1757349.577 FT STATE: KENTUCKY  
EASTING: 893491.729 FT COUNTY: CALLOWAY  
ELEVATION: 463.35 FT (GPS)  
LATITUDE: N 36°37'36.69803" LONGITUDE: W 088°17'43.97582"  
SCALE: 1.000021031 CONVERGENCE: -1°32'37.60639"  
PLANE AZI. TO AZI. MARK:

To Reach: From the intersection of State Route 2075  
and CC Lowry Dr., go east on CC Lowry Dr. about  
0.5 miles to the station on the left.

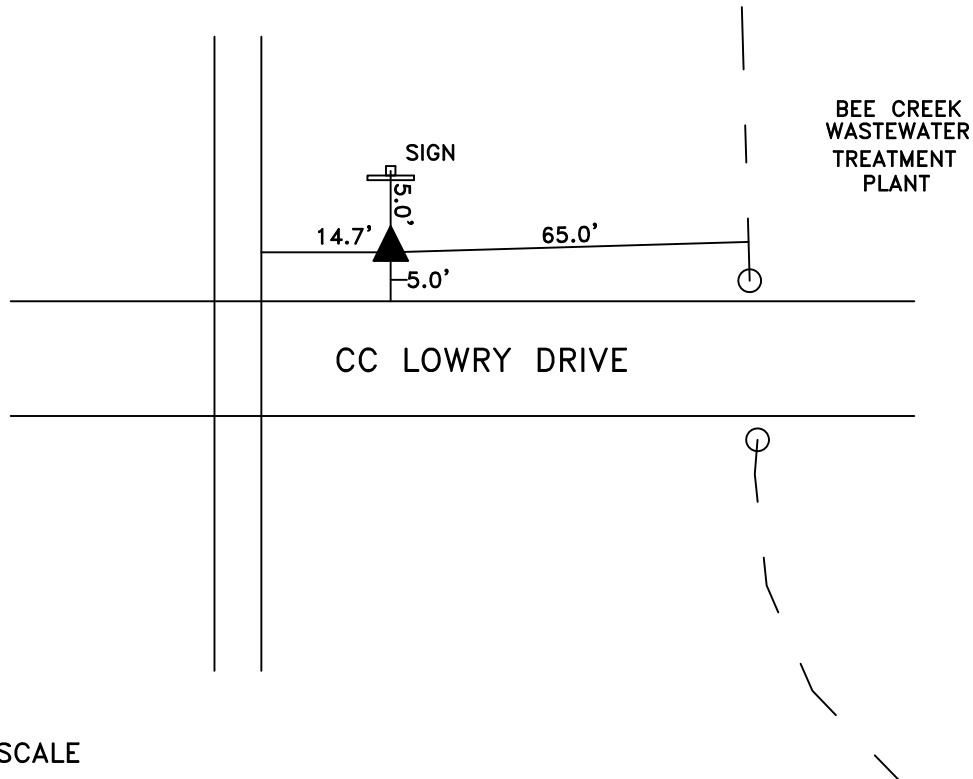

GRW Aerial Surveys, Inc.  
801 Corporate Dr. Lexington Ky. 40503  
(859)223-3999